

Report Number
F19305-4005
Account Number
37539

To: HELENA AGR-ENTERPRISES
6525 TOWN LINE RD
WEST BEND, WI 53090-9311

Field: 7367-7

For: CHEESEVILLE DAIRY

County: WASHINGTON
Soil: UNKNOWN
Plow Depth: 6
Acres:

Date Received: 11/1/2019
Date Reported: 11/5/2019

SOIL TEST REPORT

Page: 1 of 1



3505 Conestoga Dr.
Fort Wayne, IN 46808
260.483.4759
algreatlakes.com

Sample ID	Lab Number	OM *	P *	K *	Mg **	Ca **	Soil pH	Buffer pH	CEC **	Cation Saturation **				S	Zn	Mn	Fe	Cu	B	Bicarb-P ppm**	NO3-N ppm**	
		%	ppm	ppm	ppm	ppm	meq/100g	pH	%K	%Mg	%Ca	%H										
1	14730	2.2	114	155	355	1250	7.0		9.6	4.1	30.8	65.1										
2	14731	2.2	183	150	325	1100	7.2		8.6	4.5	31.5	64.0										
Average		2.2	149 ^v	153 ^v	340	1175	7.1		9.1	4.3	31.2	64.5										

WI DATCP Laboratory Certification Number 01-15-03-201

Report reviewed and approved by our professional agronomy staff.

* Soil Test Recommendations for Field, Vegetable and Fruit Crops, UW A2809, 2012. ** Recommended Chemical Soil Test Procedures for the North Central Region, NCR No. 221, 2012. ^v Weighted average, UW-A2809.

Report Number
F19305-4050
Account Number
37539



a&lgreatlakes
LABORATORIES
Scientists who don't mind getting dirty.

3505 Conestoga Dr.
Fort Wayne, IN 46808
260.483.4759
a@greatlakes.com

To: HELENA AGRI-ENTERPRISES
6525 TOWN LINE RD
WEST BEND, WI 53090-9311

For: CHEESEVILLE DAIRY
Field: 7367-1

County: WASHINGTON
Soil: UNKNOWN
Plow Depth: 6
Acres:

Date Received: 11/1/2019
Date Reported: 11/5/2019

SOIL TEST REPORT

Sample ID	Lab Number	OM *	P *	K *	Mg **	Ca **	Soil pH	Buffer pH	CEC **	Cation Saturation **				S	Zn	Mn	Fe	Cu	B	Bicarb-P	NO3-N	
		%	ppm	ppm	ppm	ppm			meq/100g	%K	%Mg	%Ca	%H	ppm	ppm	ppm	ppm	ppm	ppm	ppm	ppm	
9	14964	2.6	58	266	535	1500	7.7		12.6	5.4	35.3	59.3										
10	14965	2.2	79	209	460	1400	7.6		11.4	4.7	33.7	61.6										
11	14966	2.5	65	227	565	1550	7.5		13.0	4.5	36.1	59.4										
12	14967	2.5	85	224	455	1400	7.7		11.4	5.1	33.4	61.6										
Average		2.4	72 ^v	232 ^v	504	1463	7.6		12.1	4.9	34.6	60.5										

WI DATCP Laboratory Certification Number 01-15-03-201

Report reviewed and approved by our professional agronomy staff.

* Soil Test Recommendations for Field, Vegetable and Fruit Crops, UW A2809, 2012. ** Recommended Chemical Soil Test Procedures for the North Central Region, NCR No. 221, 2012. ^v Weighted average, UW-A2809.



a&lgreatlakes
LABORATORIES
Scientists who don't mind getting dirty.™

3505 Conestoga Dr.
Fort Wayne, IN 46808
260.483.4759
a@greatlakes.com

To: HELENA AGRI-ENTERPRISES
6525 TOWN LINE RD
WEST BEND, WI 53090-9311
For: CHEESEVILLE DAIRY
Field: 7367-1
Soil: UNKNOWN
Plow Depth: 6
Acres:

Date Received: 11/1/2019
Date Reported: 11/5/2019

SOIL TEST REPORT

Sample ID	Lab Number	OM %	P *	K *	Mg** ppm	Ca** ppm	Soil pH	Buffer pH	CEC** meq/100g	Cation Saturation**				S ppm	Zn ppm	Mn ppm	Fe ppm	Cu ppm	B ppm	Bicarb-P ppm	NO3-N ppm**											
										%K	%Mg	%Ca	%H																			
1	14859	2.5	101	240	475	1400	7.5	7.5	11.6	5.3	34.2	60.5	60.2	35.8	3.9	3.4	36.6	60.0	58.8	4.5	36.7	62.6	64.9	30.4	4.7	32.9	32.1	62.8	62.4	62.8	61.5	
2	14860	2.2	58	179	500	1400	7.4	7.4	11.6	3.9	35.8	60.2	60.2	35.8	3.9	3.4	36.6	60.0	58.8	4.5	36.7	62.6	64.9	30.4	4.7	32.9	32.1	62.8	62.4	62.8	61.5	
3	14861	2.3	65	177	585	1600	7.5	7.5	13.3	3.4	36.6	60.0	60.2	35.8	3.9	3.4	36.6	60.0	58.8	4.5	36.7	62.6	64.9	30.4	4.7	32.9	32.1	62.8	62.4	62.8	61.5	
4	14862	2.4	91	210	525	1400	7.6	7.6	11.9	4.5	36.7	62.6	64.9	30.4	4.7	32.9	32.1	62.8	62.8	4.5	36.7	62.6	64.9	30.4	4.7	32.9	32.1	62.8	62.4	62.8	61.5	
5	14863	1.9	87	150	330	1050	7.3	7.3	8.4	4.6	32.8	62.6	64.9	30.4	4.7	32.9	32.1	62.8	62.8	4.6	32.8	62.6	64.9	30.4	4.7	32.9	32.1	62.8	62.4	62.8	61.5	
6	14864	2.1	83	189	380	1350	7.6	7.6	10.4	4.7	30.4	64.9	64.9	30.4	4.7	30.4	64.9	64.9	64.9	4.7	30.4	64.9	64.9	30.4	4.7	30.4	64.9	64.9	64.9	64.9	64.9	61.5
7	14865	2.0	73	174	380	1200	7.6	7.6	9.6	4.6	32.9	62.4	62.4	32.9	4.6	32.9	62.4	62.4	62.4	4.6	32.9	62.4	62.4	32.9	4.6	32.9	62.4	62.4	62.4	62.4	62.4	61.5
8	14866	2.3	89	222	430	1400	7.6	7.6	11.2	5.1	32.1	62.8	62.8	32.1	5.1	32.1	62.8	62.8	62.8	5.1	32.1	62.8	62.8	32.1	5.1	32.1	62.8	62.8	62.8	62.8	62.8	61.5
Average		2.2	81 ^v	193 ^v	451	1350	7.5	7.5	11.0	4.5	34.0	61.5	61.5	34.0	4.5	34.0	61.5	61.5	61.5	4.5	34.0	61.5	61.5	34.0	4.5	34.0	61.5	61.5	61.5	61.5	61.5	61.5

WI DATCP Laboratory Certification Number 01-15-03-201
Report reviewed and approved by our professional agronomy staff.

* Soil Test Recommendations for Field, Vegetable and Fruit Crops, UW A2809, 2012. ** Recommended Chemical Soil Test Procedures for the North Central Region, NCR No. 221, 2012. ^v Weighted average, UW-A2809.

Report Number
F19305-4005
Account Number
37539



a & great lakes
LABORATORIES
Scientists who don't mind getting dirty.

3505 Conestoga Dr.
Fort Wayne, IN 46808
260.483.4759
algreatlakes.com

To: HELENA AGRICULTURE ENTERPRISES
6525 TOWN LINE RD
WEST BEND, WI 53090-9311

For: CHEESEVILLE DAIRY
Field: 7367-7

County: WASHINGTON
Soil: UNKNOWN
Plow Depth: 6
Acres:

Date Received: 11/1/2019
Date Reported: 11/5/2019

SOIL TEST REPORT

Sample ID	Lab Number	OM %	P *	K *	Mg **	Ca **	Soil pH	Buffer pH	CEC **	Cation Saturation **				S	Zn	Mn	Fe	Cu	B	Bicarb-P	NO3-N	
										%K	%Mg	%Ca	%H									
1	14730	2.2	114	155	355	1250	7.0		9.6	4.1	30.8	65.1										
2	14731	2.2	183	150	325	1100	7.2		8.6	4.5	31.5	64.0										
Average		2.2	149 ^v	153 ^v	340	1175	7.1		9.1	4.3	31.2	64.5										

WI DATCP Laboratory Certification Number 01-15-03-201
 Report reviewed and approved by our professional agronomy staff.
 * Soil Test Recommendations for Field, Vegetable and Fruit Crops, UW A2809, 2012. ** Recommended Chemical Soil Test Procedures for the North Central Region, NCR No. 221, 2012. ^v Weighted average, UW-A2809.



a&lgreatlakes
LABORATORIES
Scientists who don't mind getting dirty.

3505 Conestoga Dr.
Fort Wayne, IN 46808
260.483.4759
a@greatlakes.com

To: HELENA AGRI-ENTERPRISES
6525 TOWN LINE RD
WEST BEND, WI 53090-9311
For: CHEESEVILLE DAIRY
Field: 7367-2M
Soil: UNKNOWN
Plow Depth: 6
Acres:

Date Received: 11/1/2019
Date Reported: 11/5/2019

SOIL TEST REPORT

Sample ID	Lab Number	OM %	P *	K *	Mg **	Ca **	Soil pH	Buffer pH	CEC **	Cation Saturation **				S	Zn	Mn	Fe	Cu	B	bicarb-p	NO3-N	
										%K	%Mg	%Ca	%H									
1	14968	2.4	81	247	430	1300	7.6		10.7	5.9	33.4	60.7										
2	14969	2.1	63	197	495	1350	7.4		11.4	4.4	36.2	59.3										
3	14970	2.2	74	219	465	1300	7.0		10.9	5.1	35.4	59.4										
4	14971	2.1	72	191	515	1450	7.4		12.0	4.1	35.7	60.3										
5	14972	2.6	99	239	565	1550	7.6		13.1	4.7	36.0	59.3										
6	14973	2.3	73	195	495	1500	6.8		12.1	4.1	34.0	61.9										
7	14974	2.3	86	224	550	1550	7.6		12.9	4.4	35.5	60.0										
8	14975	2.1	118	208	440	1450	7.6		11.4	4.7	32.0	63.3										
9	14976	2.4	88	214	490	1400	7.6		11.6	4.7	35.1	60.2										
Average		2.3	84 ^v	215 ^v	494	1428	7.4		11.8	4.7	34.8	60.5										

WI DATCP Laboratory Certification Number 01-15-03-201
 Report reviewed and approved by our professional agronomy staff.
 * Soil Test Recommendations for Field, Vegetable and Fruit Crops, UW A2809, 2012. ** Recommended Chemical Soil Test Procedures for the North Central Region, NCR No. 221, 2012. ^v Weighted average, UW-A2809.

Report Number
F19305-4050
Account Number
37539



a&lgreatlakes
LABORATORIES
Scientists who don't mind getting dirty.™

3505 Conestoga Dr.
Fort Wayne, IN 46808
260.483.4759
a@greatlakes.com

To: HELENA AGRI-ENTERPRISES
6525 TOWN LINE RD
WEST BEND, WI 53090-9311

Field: 7367-1

For: CHEESEVILLE DAIRY
County: WASHINGTON
Soil: UNKNOWN
Plow Depth: 6
Acres:

SOIL TEST REPORT

Date Received: 11/1/2019
Date Reported: 11/5/2019

Page: 1 of 1

Sample ID	Lab Number	OM *	P *	K *	Mg **	Ca **	Soil pH	Buffer pH	CEC **	Cation Saturation **				S	Zn	Mn	Fe	Cu	B	Bicarb-P ppm	NO3-N ppm**	
		%	ppm	ppm	ppm	ppm	ppm	meq/100g	%K	%Mg	%Ca	%H										
9	14964	2.6	58	266	535	1500	7.7	7.7	12.6	5.4	35.3	59.3	5.4	35.3	59.3	61.6	61.6	61.6	61.6	61.6	61.6	61.6
10	14965	2.2	79	209	460	1400	7.6	7.6	11.4	4.7	33.7	61.6	4.7	33.7	61.6	61.6	61.6	61.6	61.6	61.6	61.6	
11	14966	2.5	65	227	565	1550	7.5	7.5	13.0	4.5	36.1	59.4	4.5	36.1	59.4	59.4	59.4	59.4	59.4	59.4	59.4	
12	14967	2.5	85	224	455	1400	7.7	7.7	11.4	5.1	33.4	61.6	5.1	33.4	61.6	61.6	61.6	61.6	61.6	61.6	61.6	
Average		2.4	72^	232^	504	1463	7.6	7.6	12.1	4.9	34.6	60.5	4.9	34.6	60.5	60.5	60.5	60.5	60.5	60.5	60.5	

WI DATCP Laboratory Certification Number 01-15-03-201

Report reviewed and approved by our professional agronomy staff.

* Soil Test Recommendations for Field, Vegetable and Fruit Crops, UW A2809, 2012. ** Recommended Chemical Soil Test Procedures for the North Central Region, NCR No. 221, 2012. ^ Weighted average, UW-A2809.

Report Number
F19305-4052
Account Number
37539



a & greatlakes
LABORATORIES
Scientists who don't mind getting dirty.

3505 Conestoga Dr.
Fort Wayne, IN 46808
260.483.4759
algreatlakes.com

To: HELENA AGRILENTERPRISES
6525 TOWN LINE RD
WEST BEND, WI 53090-9311
Field: 3473-1
Plow Depth: 6
Acres:

Date Received: 11/1/2019
Date Reported: 11/5/2019

SOIL TEST REPORT

Page: 1 of 1

Sample ID	Lab Number	OM %	P *	K *	Mg **	Ca **	Soil pH	Buffer pH	CEC **	Cation Saturation **				S	Zn	Mn	Fe	Cu	B	Bicarb-P ppm	NO3-N ppm**	
										%K	%Mg	%Ca	%H									
1	14980	2.3	50	161	695	2000	7.7	7.7	16.2	2.5	35.7	61.7	62.4	61.3	64.7	62.4	63.8	63.1	63.8	62.4	63.8	63.8
2	14981	2.3	54	138	590	1750	7.7	8.0	14.0	2.5	35.1	62.4	61.3	64.7	62.4	63.8	63.1	63.8	62.4	63.8	63.8	63.8
3	14982	2.4	97	201	770	2200	8.0	8.0	17.9	2.9	35.8	61.3	61.3	64.7	62.4	63.8	63.1	63.8	62.4	63.8	63.8	63.8
4	14983	3.1	100	242	695	2350	7.4	7.9	18.2	3.4	31.9	64.7	62.4	63.8	63.1	63.8	63.1	63.8	62.4	63.8	63.8	63.8
5	14984	2.5	71	213	675	2050	7.9	7.9	16.4	3.3	34.3	62.4	63.8	63.1	63.8	63.1	63.8	62.4	63.8	63.8	63.8	63.8
6	14985	2.7	114	271	615	2050	8.0	8.0	16.1	4.3	31.9	63.8	63.8	63.1	63.8	63.1	63.8	62.4	63.8	63.8	63.8	63.8
7	14986	2.5	74	155	620	1900	7.9	7.9	15.1	2.6	34.3	63.1	63.8	63.1	63.8	63.1	63.8	62.4	63.8	63.8	63.8	63.8
8	14987	2.6	83	226	525	1650	7.6	7.6	13.2	4.4	33.1	62.5	62.5	62.5	62.5	62.5	62.5	62.5	62.5	62.5	62.5	62.5
9	14988	2.4	107	310	645	1950	8.0	8.0	15.9	5.0	33.8	61.2	61.2	61.2	61.2	61.2	61.2	61.2	61.2	61.2	61.2	61.2
10	14989	2.9	110	254	600	1950	7.5	7.5	15.4	4.2	32.5	63.3	63.3	63.3	63.3	63.3	63.3	63.3	63.3	63.3	63.3	63.3
11	14990	2.6	155	296	480	1550	7.4	7.4	12.5	6.1	32.0	62.0	62.0	62.0	62.0	62.0	62.0	62.0	62.0	62.0	62.0	62.0
12	14991	3.1	172	310	475	1750	7.6	7.6	13.5	5.9	29.3	64.8	64.8	64.8	64.8	64.8	64.8	64.8	64.8	64.8	64.8	64.8
Average		2.6	99 ^v	231 ^v	615	1929	7.7	7.7	15.4	3.9	33.3	62.8	62.8	62.8	62.8	62.8	62.8	62.8	62.8	62.8	62.8	62.8

WI DATCP Laboratory Certification Number 01-15-03-201

Report reviewed and approved by our professional agronomy staff.

* Soil Test Recommendations for Field, Vegetable and Fruit Crops, UW A2809, 2012. ** Recommended Chemical Soil Test Procedures for the North Central Region, NCR No. 221, 2012. ^v Weighted average, UW-A2809.

*hay fields get 7,000 gal manure after 1st crop

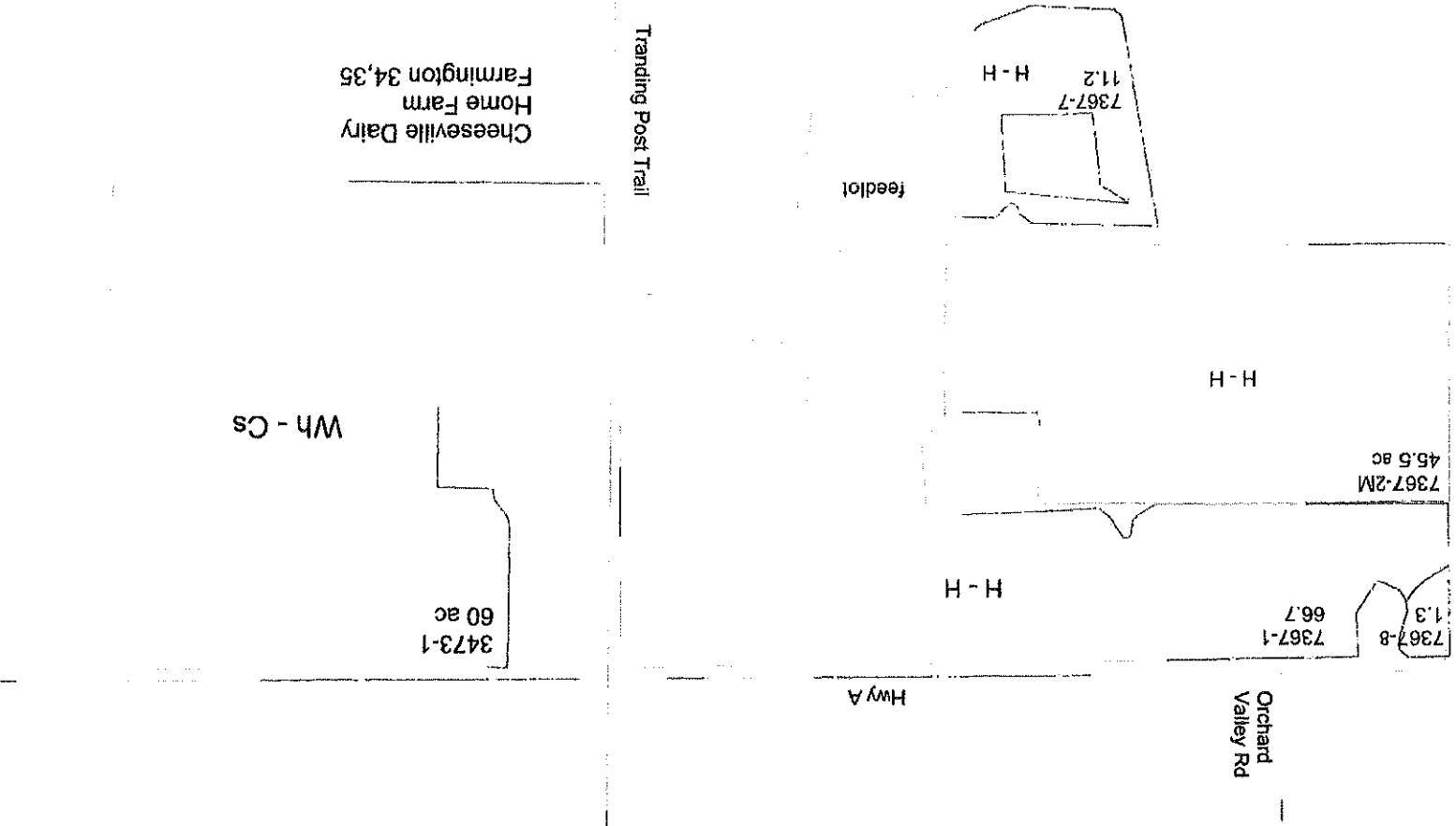

Cheeseville Dairy
Home Farm
Farmington 34,35

WH - Cs

3473-1
60 ac

Hwy A

Orchard
Valley Rd

Tranding Post Trail

feedlot

7367-7
11.2
H-H

H-H

7367-2M
45.5 ac

H-H

7367-1
66.7

7367-8
1.3



To: HELENA AGR-ENTERPRISES
6525 TOWN LINE RD
WEST BEND, WI 53090-9311
Field: 5843-1
For: CHEESEVILLE DAIRY
County: WASHINGTON
Soil: UNKNOWN
Plow Depth: 6
Acres:

Date Received: 11/1/2019
Date Reported: 11/5/2019

SOIL TEST REPORT

Sample ID	Lab Number	OM %	P *	K *	Mg **	Ca **	Soil pH	Buffer pH	CEC **	Cation Saturation **				S	Zn	Mn	Fe	Cu	B	Bicarb-P	NO3-N	
										%H	%Ca	%Mg	%K									
1	14946	3.7	32	186	785	2350	7.8	7.8	18.8	2.5	34.9	62.6	61.8	3.0	35.2	60.9	61.2	60.9	61.8	61.8	61.8	61.8
2	14947	3.8	26	211	770	2250	7.8	7.9	18.2	3.0	35.2	61.8	61.8	3.0	35.2	60.9	61.2	60.9	61.8	61.8	61.8	61.8
3	14948	3.6	21	204	805	2250	7.9	7.9	18.5	2.8	36.3	60.9	61.2	2.8	36.3	60.9	61.2	60.9	61.8	61.8	61.8	61.8
4	14949	3.5	30	221	865	2450	7.3	7.3	20.0	2.8	36.0	61.2	61.2	2.8	36.0	60.9	61.2	60.9	61.8	61.8	61.8	61.8
5	14952	3.6	36	244	900	2350	7.8	7.8	19.9	3.1	37.7	59.1	59.1	3.1	37.7	59.1	59.1	59.1	61.8	61.8	61.8	61.8
6	14953	4.1	41	224	905	2550	6.9	6.9	20.9	2.8	36.1	61.1	61.1	2.8	36.1	60.9	61.2	60.9	61.8	61.8	61.8	61.8
Average		3.7	27 ^v	215 ^v	838	2367	7.6	7.6	19.4	2.8	36.0	61.1	61.1	2.8	36.0	60.9	61.2	60.9	61.8	61.8	61.8	61.8

WI DATCP Laboratory Certification Number 01-15-03-201
 Report reviewed and approved by our professional agronomy staff.
 * Soil Test Recommendations for Field, Vegetable and Fruit Crops, UW A2809, 2012. ** Recommended Chemical Soil Test Procedures for the North Central Region, NCR No. 221, 2012. ^v Weighted average, UW-A2809.



a&lgreatlakes
LABORATORIES
Scientists who don't mind getting dirty.™

To: HELENA AGRi-ENTERPRISES
6525 TOWN LINE RD
WEST BEND, WI 53090-9311
For: CHEESEVILLE DAIRY
Field: 5843-2

County: WASHINGTON
Soil: UNKNOWN
Plow Depth: 6
Acres:

SOIL TEST REPORT

Date Received: 11/1/2019
Date Reported: 11/5/2019

Sample ID	Lab Number	OM %	P *	K *	Mg** ppm	Ca** ppm	Soil pH	Buffer pH	CEC** meq/100g	Cation Saturation**				S ppm	Zn ppm	Mn ppm	Fe ppm	Cu ppm	B ppm	Bicarb-P ppm	NO3-N ppm**	
										%K	%Mg	%Ca	%H									
1	14954	3.7	39	212	765	2350	7.9	18.7	2.9	34.1	62.9	61.9	63.0									
2	14955	2.9	34	165	650	2100	7.7	16.3	2.6	33.2	64.3	36.0	34.4									
3	14956	2.6	15	132	680	1950	7.7	15.8	2.1	36.0	61.9	63.0	63.0									
Average		3.1	25 ^v	149 ^v	698	2133	7.8															

WI DATCP Laboratory Certification Number 01-15-03-201
 Report reviewed and approved by our professional agronomy staff.
 * Soil Test Recommendations for Field, Vegetable and Fruit Crops, UW A2809, 2012. ** Recommended Chemical Soil Test Procedures for the North Central Region, NCR No. 221, 2012. ^v Weighted average, UW-A2809.

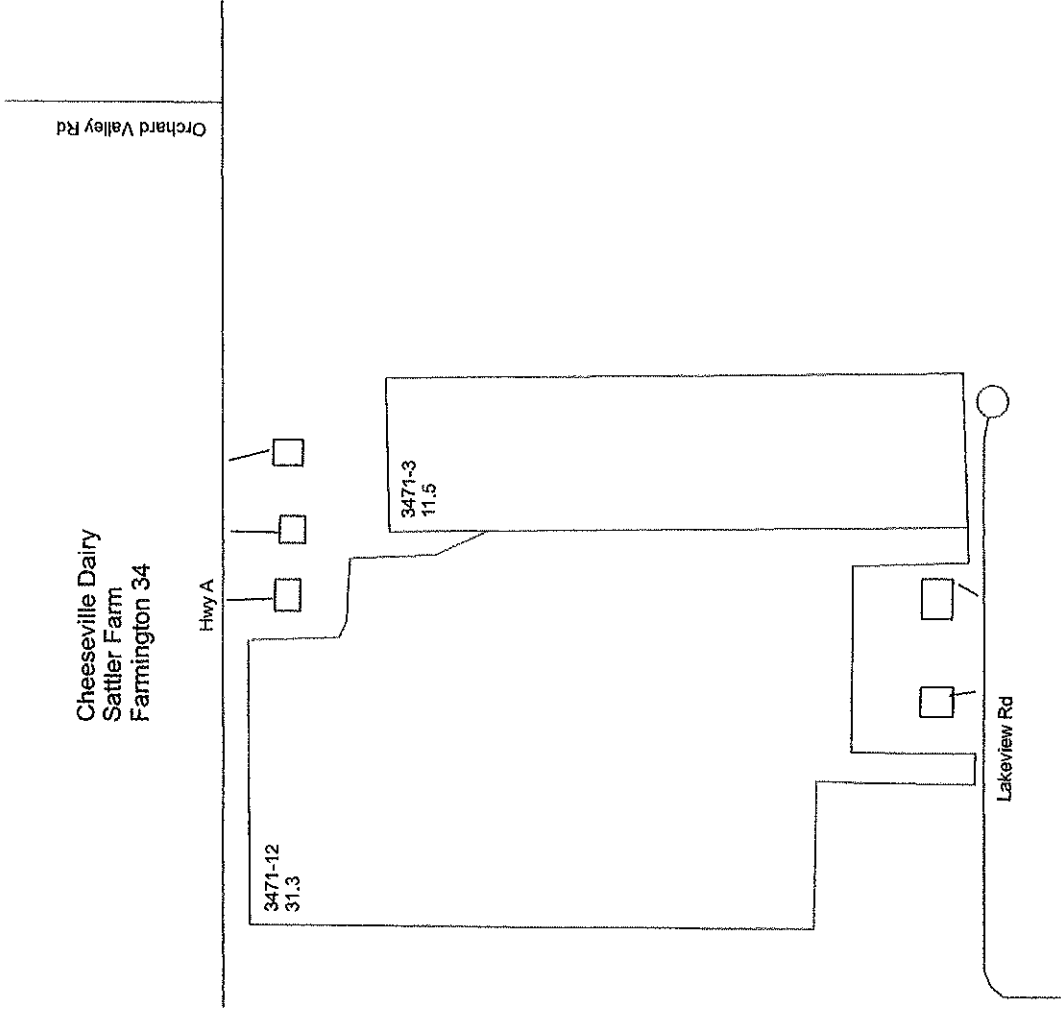



a&lgreatlakes
LABORATORIES
Scientists who don't mind getting dirty.™

3505 Conestoga Dr.
Fort Wayne, IN 46808
260.483.4759
algreatlakes.com

To: HELENA AGRi-ENTERPRISES
6525 TOWN LINE RD
WEST BEND, WI 53090-9311
Field: 3473-1
For: CHEESEVILLE DAIRY
County: WASHINGTON
Soil: UNKNOWN
Plow Depth: 6
Acres:

Date Received: 11/1/2019
Date Reported: 11/5/2019

SOIL TEST REPORT

Sample ID	Lab Number	OM %	P *	K *	Mg **	Ca **	Soil pH	Buffer pH	CEC **	Cation Saturation **				S	Zn	Mn	Fe	Cu	B	Bicarb-P	NO3-N
										%K	%Mg	%Ca	%H								
1	14980	2.3	50	161	695	2000	7.7	7.7	16.2	2.5	35.7	61.7									
2	14981	2.3	54	138	590	1750	7.7	7.7	14.0	2.5	35.1	62.4									
3	14982	2.4	97	201	770	2200	8.0	8.0	17.9	2.9	35.8	61.3									
4	14983	3.1	100	242	695	2350	7.4	7.4	18.2	3.4	31.9	64.7									
5	14984	2.5	71	213	675	2050	7.9	7.9	16.4	3.3	34.3	62.4									
6	14985	2.7	114	271	615	2050	8.0	8.0	16.1	4.3	31.9	63.8									
7	14986	2.5	74	155	620	1900	7.9	7.9	15.1	2.6	34.3	63.1									
8	14987	2.6	83	226	525	1650	7.6	7.6	13.2	4.4	33.1	62.5									
9	14988	2.4	107	310	645	1950	8.0	8.0	15.9	5.0	33.8	61.2									
10	14989	2.9	110	254	600	1950	7.5	7.5	15.4	4.2	32.5	63.3									
11	14990	2.6	155	296	480	1550	7.4	7.4	12.5	6.1	32.0	62.0									
12	14991	3.1	172	310	475	1750	7.6	7.6	13.5	5.9	29.3	64.8									
Average		2.6	99 ^v	231 ^v	615	1929	7.7	7.7	15.4	3.9	33.3	62.8									

WI DATCP Laboratory Certification Number 01-15-03-201

Report reviewed and approved by our professional agronomy staff.

* Soil Test Recommendations for Field, Vegetable and Fruit Crops, UW A2809, 2012. ** Recommended Chemical Soil Test Procedures for the North Central Region, NCR No. 221, 2012. v Weighted average, UW-A2809.

*hay fields get 7,000 gal manure after 1st crop

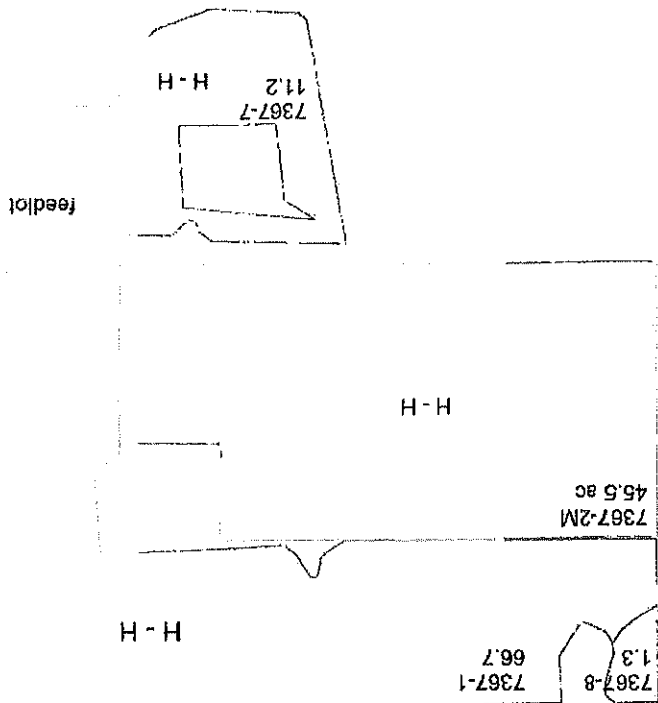

Orchard
Valley Rd

Hwy A

Tranding Post Trail

Cheeseville Dairy
Home Farm
Farmington 34,35

Wh - Cs

3473-1
60 ac



a&lgreatlakes
LABORATORIES
Scientists who don't mind getting dirty.™

To: CHEESEVILLE DAIRY

HELENA AGRI-ENTERPRISES
6525 TOWN LINE RD
WEST BEND, WI 53090-9311

Field: 3471-3

County: WASHINGTON
Soil: UNKNOWN
Plow Depth: 6
Acres:

SOIL TEST REPORT

Date Received: 11/1/2019
Date Reported: 11/5/2019

Sample ID	Lab Number	OM *	P *	K *	Mg **	Ca **	Soil pH	Buffer pH	CEC **	Cation Saturation **			S	Zn	Mn	Fe	Cu	B	Biarb-p	NO3-N	
		%	ppm	ppm	ppm	ppm	ppm	meq/100g	%K	%Mg	%Ca	%H									
1	14732	2.3	43	144	590	1600	7.6	7.4	13.3	2.8	37.0	60.2	61.9								
2	14733	2.4	37	105	540	1550	7.4	7.4	12.5	2.2	35.9	61.1									
Average		2.3	40 ^v	125 ^v	565	1575	7.5														

WI DATCP Laboratory Certification Number 01-15-03-201

Report reviewed and approved by our professional agronomy staff.

* Soil Test Recommendations for Field, Vegetable and Fruit Crops, UW A2809, 2012. ** Recommended Chemical Soil Test Procedures for the North Central Region, NCR No. 221, 2012. ^v Weighted average, UW-A2809.

Cheeseville Dairy
Meadow Rd
Farmington 26

5843-1
27.7

Wheat - Cs
*20,000 fall manure

5843-2
64.4

Cs - Wheat

Meadow Rd

Trading Post Trail

HWY A